



SPECIFICATION

- * Body & end caps quality investment casting
- * with ISO 5211 direct mounting pad
- * Adjustable stem packing
- * Available in stainless steel or carbon steel
- * Blow-out proof stem design
- * 100% air tested under water at 80-100 psi
- * Working pressure: 1000/ 800 psi
- * Temperature range -20°F to 450°F
- * with locking function
- * End type: threaded, socket weld, butt weld

OPTION

- * Spring handle (dead man handle)
- * Oval handle
- * Automation application
- * with handle and limit switch box
- * PTFE/ PFA coating (40-70 um)
- * V-ball for control valve in 15°, 30°, 60°, 90°, slot
- * Hastalloy C/ Super duplex/ Alloy 20/ Monel

ZIPSON'S 302F, 3-piece ball valve with ISO direct mounting pad is designed for most of the industrial pipe line as full port product. The ends types can be Thread/ Socket Weld/ Butt Weld. 3-piece ball valve is well designed for reparation on-line. Different material of soft kits will be applicable for different working circumstance.

The standard bare stem type is well designed for mounting actuator directly. ZIPSON offer pneumatic/ electric actuator and limit switch box/ solenoid valve/ modulating controller....assembling without further charge.

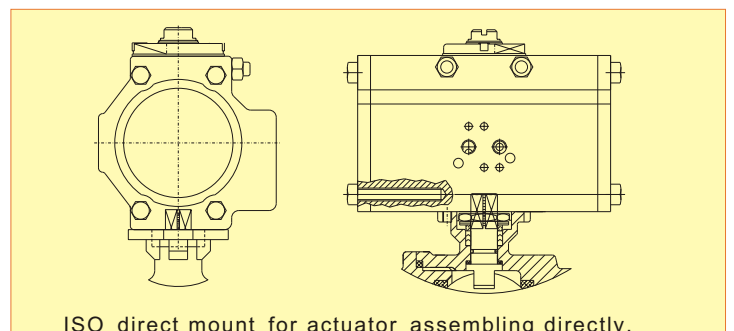
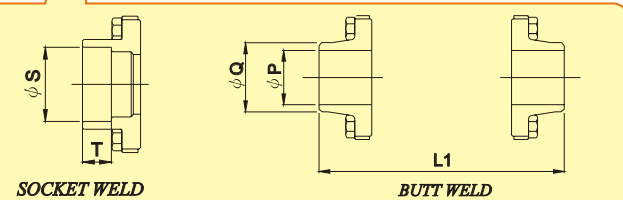
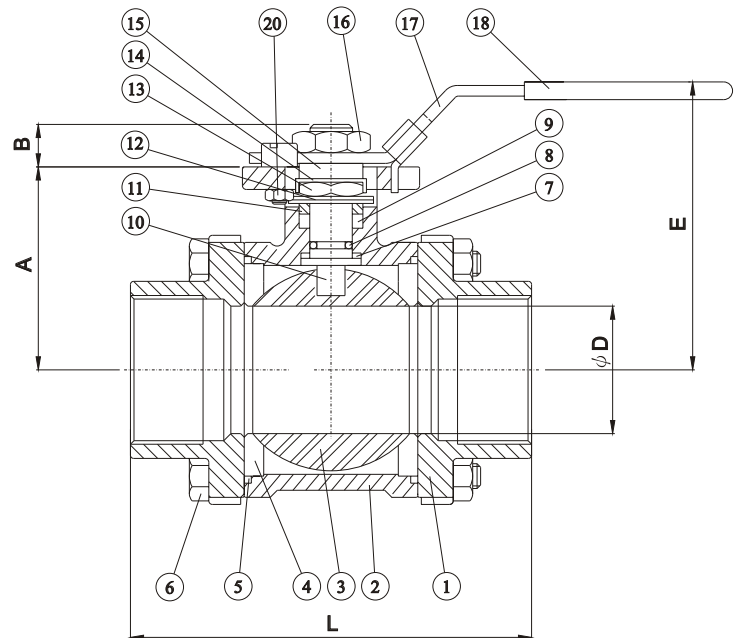
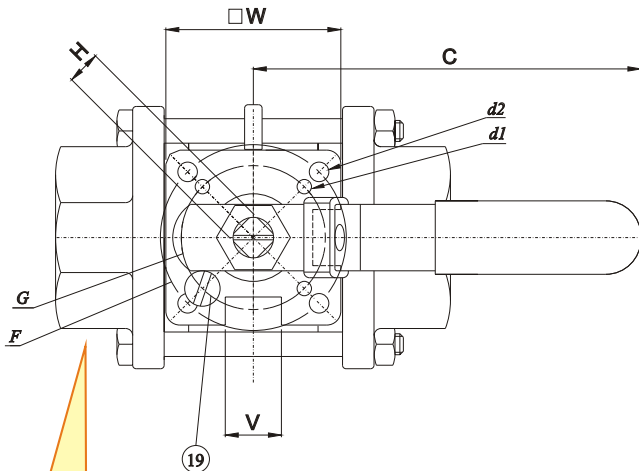

DIMENSIONS (mm)

SIZE	A	B	C	D	d1	d2	E	F	G	H	L	S	T	P	Q	L1	V	W
1/4"	37	11	130	11	6.0	6.0	58	36	42	9	60.5	14.2	11.1	10	17	60.5	19	44
3/8"	37	11	130	12.5	6.0	6.0	58	36	42	9	60.5	17.5	11.1	12	19	60.5	19	44
1/2"	37	11	130	15	6.0	6.0	58	36	42	9	63.5	21.8	12.7	15	21.5	63.5	19	44
3/4"	40	11	130	20	6.0	6.0	64	36	42	9	75.5	27.1	14.3	20	27.5	75.5	19	44
1"	48	14	155	25	6.0	7.0	77	42	50	11	86	33.8	15.9	25	34.5	86	24	52
1 1/4"	53.5	14	155	32	6.0	7.0	83	42	50	11	96	42.5	17.5	32	42.8	104	24	52
1 1/2"	63.5	18	205	38	7.0	9.0	92	50	70	14	111	48.7	19.1	38	49	117	28	53
2"	72	18	205	50	7.0	9.0	100	50	70	14	129	61.1	22.2	50	61	138	28	53
2-1/2"	92	22	290	65	9.0	11.3	140	70	102	17	152.5	73.9	22.2	65	77	170	-	-
3"	102	22	290	80	9.0	11.3	150	70	102	17	168.5	89.9	25.4	80	91	192	-	-
4"	132	26	335	100	11.3	13.5	195	102	125	22	212.5	115.2	32	100	118	226	-	-

BREAK-TORQUE VALUE (Nm/ at 0 psi)

SIZE	1/4"	3/8"	1/2"	3/4"	1"	1 1/4"	1 1/2"	2"	2-1/2"	3"	4"
GREASE	3.5	3.5	5	5.5	7	11	17	23	35	46	72
NON-GREASE	5	5	6	7	9.5	16	27	30	68	85	105

Note 1: The greases ZIPSON use including lubricant & anti-seize grease are both SILICONE-FREE.

Note 2: Strongly suggest increasing at least 30%~40% for safety factor for mounting actuator.

MATERIALS LIST

ITEM	PART NAME	MATERIALS
1	END CAP	CF8M
2	BODY	CF8M
3	BALL	SS 316
4	SEAT	PTFE
5	GASKET	PTFE
6	BOLTS	SS 304
7	THRUST WASHER	RPTFE
8	O-RING	VITON
9	STEM PACKING	PTFE
10	STEM	SS 316
11	GLAND	SS 304
12	DISK WASHES	SS 301
13	STEM NUT	SS 304
14	NUT STOP	SS 304
15	SPACE WASHER	SS 304
16	HANDLE NUT	SS 304
17	HANDLE	SS 304
18	HANDLE COVER	PLASTIC
19	STOP PIN	SS 304
20	NUT	SS 304

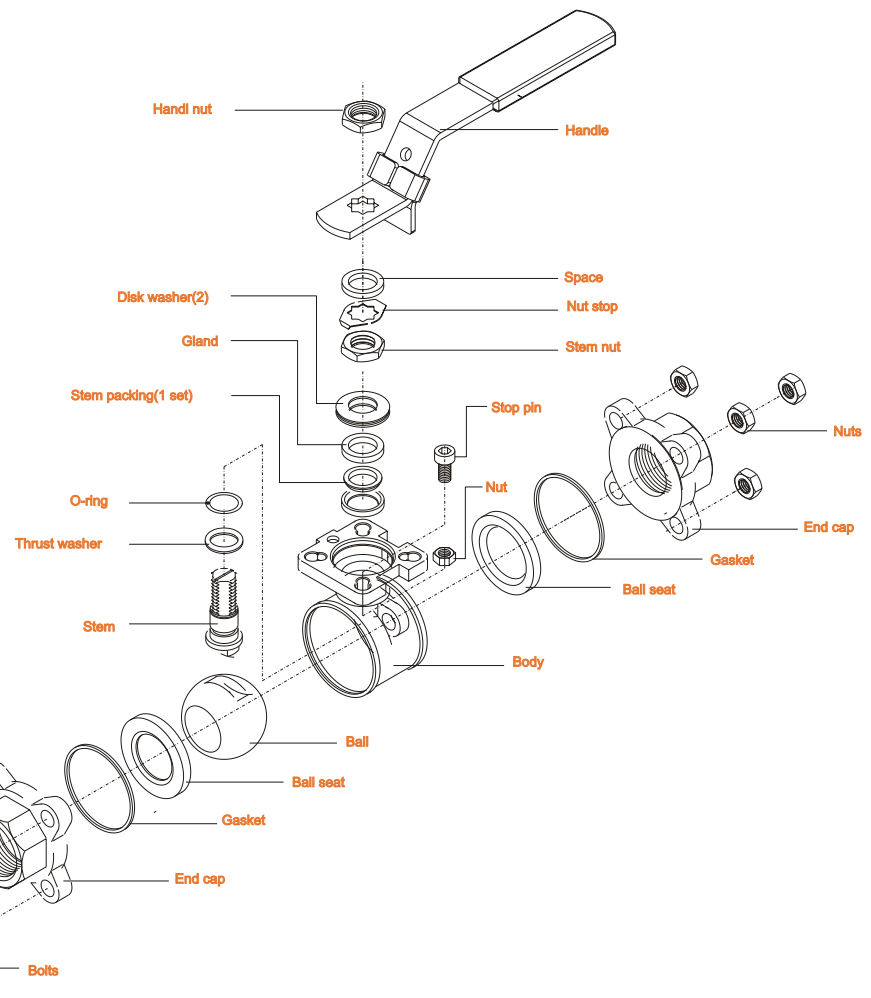

PRESSURE/ TEMPERATURE

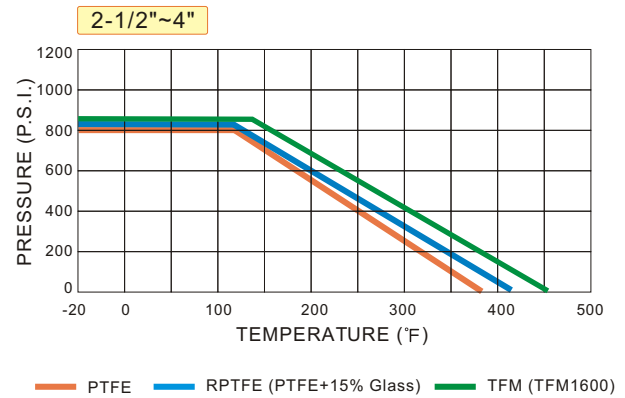
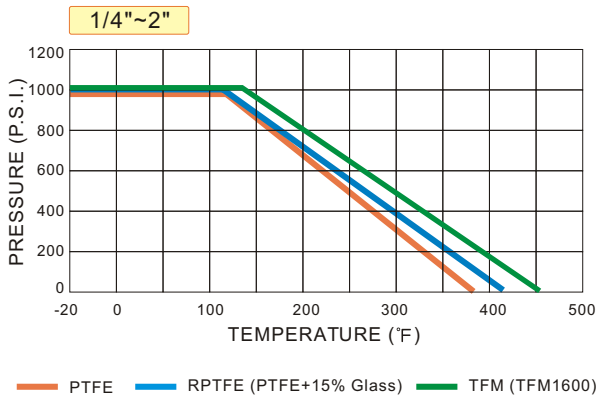

V-BALL FOR MODULATING CONTROLLER

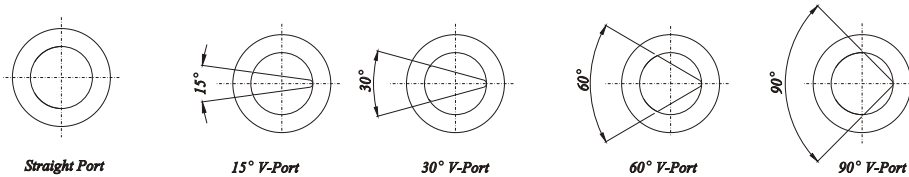

VALVE HANDLE WITH LIMIT SWITCH BOX

ZIPSON ball valve with ISO 5211 mounting pad can be with compact design for valve handle & limit switch box.

Available Type: 201D/ 302F/ 305D/ 207S/ 207F

Suggestion!

1. As dismantle the ball valve, don't forget to replace new Repair Kits, especially the gasket to prevent from leaking.
2. PTFE is better than RPTFE (+15% Glass) as operate the valve by actuator, for Glass fiber will hurt the ball and cause the torque value increasing after over 500 times operation. Another good option is TFM or PTFE+25% Carbon.
3. Before welding the valves, make sure the ends were dismantled. And welding the dismantled ends. After all the ends be cool, assemble the ends & use new gasket to prevent from leaking.